

BIOLOGICALLY ORIENTED PROSTHESES

BIOPRO

Hand and Wrist Solutions

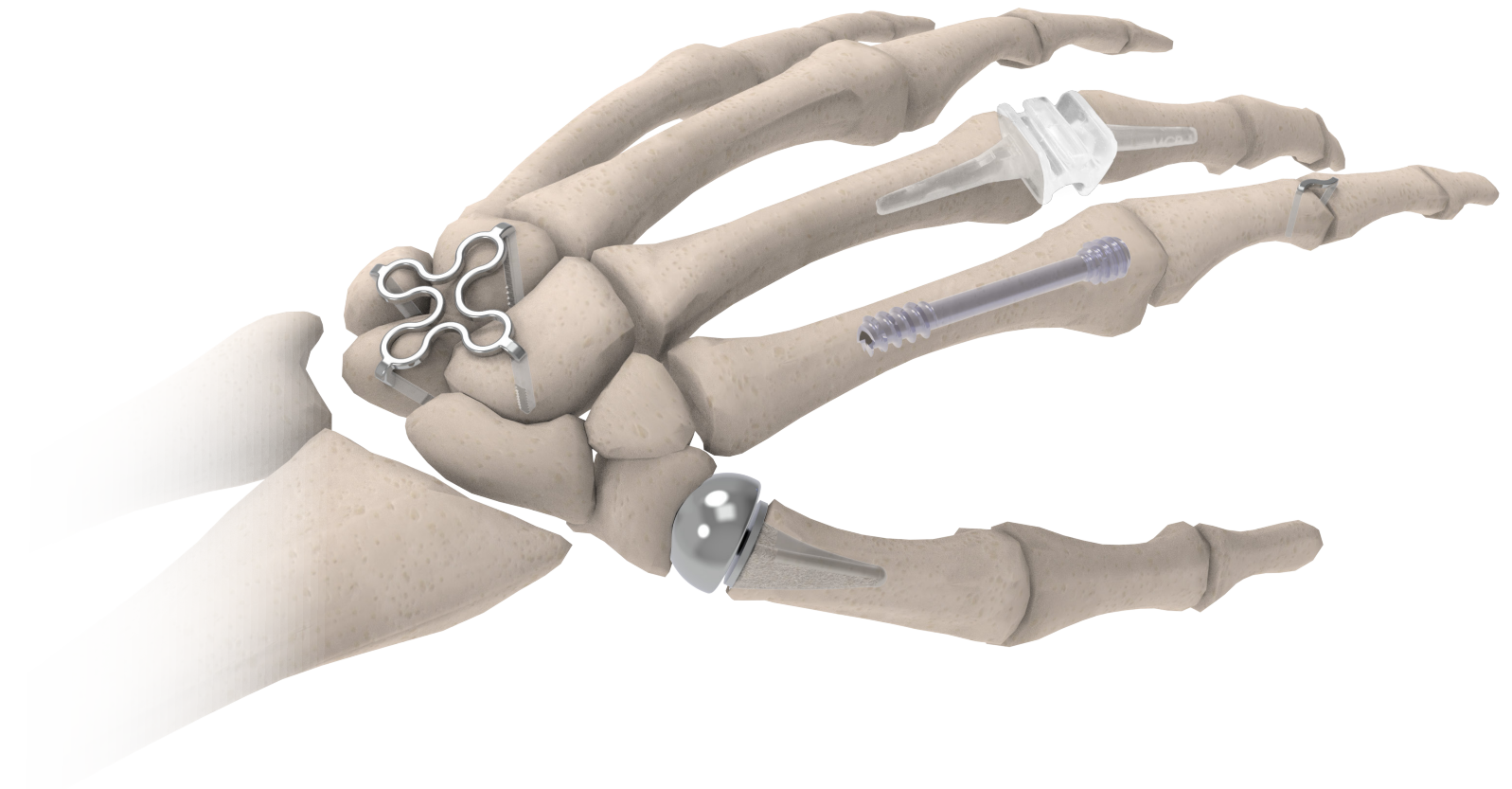

Contact information

Website:
www.bioproimplants.com

Email:
info@bioproimplants.com
orders@bioproimplants.com

Phone:
(810) 982-7777

Fax:
(810) 982-7794

Address:
2929 Lapeer Rd,
Port Huron, MI 48060

Procedure Overview

Joint Replacement

CMC Hemiarthroplasty

Modular Thumb Implant	1
Digitalis Silicone Spacer	2

Limited Wrist Arthrodesis

Four Corner Arthrodesis

Clover Staple	3
Memory Staple	4
Cannulated Compression Screws	6-7

Scaphotrapeziotrapezoid Arthrodesis

Clover Staple	3
Memory Staple	4

Joint Arthrodesis

DIP Fusion

Memory Staple	4
Digital Compression Screw	5
Cannulated Compression Screws	6-7

PIP Fusion

Memory Staple	4
Digital Compression Screw	5
Cannulated Compression Screws	6-7

CMC Fusion

Memory Staple	4
---------------	---

Fractures

Metacarpal Fractures

Cannulated Compression Screws	6-7
-------------------------------	-----

Scaphoid Fracture

Cannulated Compression Screws	6-7
-------------------------------	-----

Modular Thumb Implant

The BioPro® Modular Thumb Implant is a two-piece implant consisting of a head and a press-fit plasma-sprayed stem. The implant is designed to address carpometacarpal (CMC) joint arthritis and the challenges with past implants including: dislocation, implant loosening and subluxation. The implant is supported by two decades of combined clinical experience and research with published results of 94% survivorship at 6 years¹. The patented modular design allows the head to be sized independently of the stem to match the patient's anatomy. The modularity, along with the stem's ulnar alignment has attributed to the promising advancement of CMC implant arthroplasty.



- The stem features a 15 degree varus angle resulting in an ulnar alignment of the implant which directs the head of the implant to prevent dislocation during flexion and opposition.
- Modular design allows for 48 total size configurations
- Titanium plasma spray stem for improved biological fixation

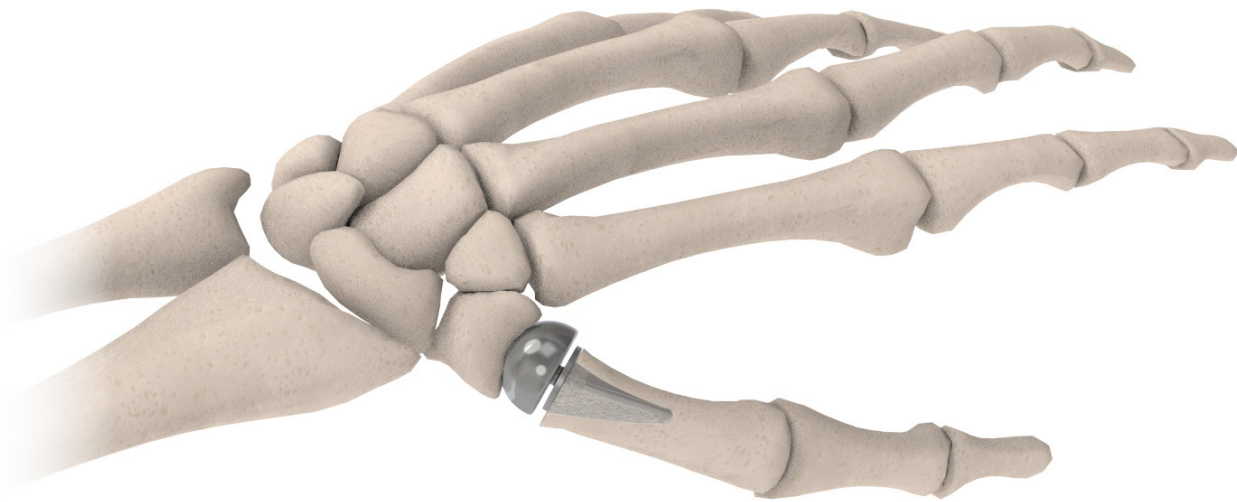

	Cobalt Chrome Heads	Titanium Heads
12mm	17199	17800
12mm+2	17238	17801
12mm+4	17500	20234
13mm	17005	17798
13mm+2	17239	17799
13mm+4	17501	20235
14mm	17006	17806
14mm+2	17240	17807
14mm+4	17507	20236
15mm	17007	17808
15mm+2	17241	17809
15mm+4	17508	20237

	Cobalt Chrome Stems	Titanium Stems
7.5mm	17596	17600
8.5mm	17597	17601
10mm	17598	17602
11.5mm	17599	17603
7.5mm+4 Revision	20050	
8.5mm+4 Revision	20048	
10mm+4 Revision	19294	
11.5mm+4 Revision	19295	

Digitalis Silicone Spacer

The Digitalis Silicone Spacer features a pre-flexed dual hinge design allowing for improved motion and longevity. The spacer is available in 5 sizes for the metacarpophalangeal (MCP) joints and 4 sizes for the proximal interphalangeal (PIP) joints.

- 15°(PIP) and 30°(MCP) pre-flexed hinge to respect the normal finger position
- T-hinge prevents hyper-extension and improves strength
- Thin stems to maintain intramedullary canal with triangular proximal section to improve stability
- Proven longevity at 10 million load cycles
- Modern instrumentation

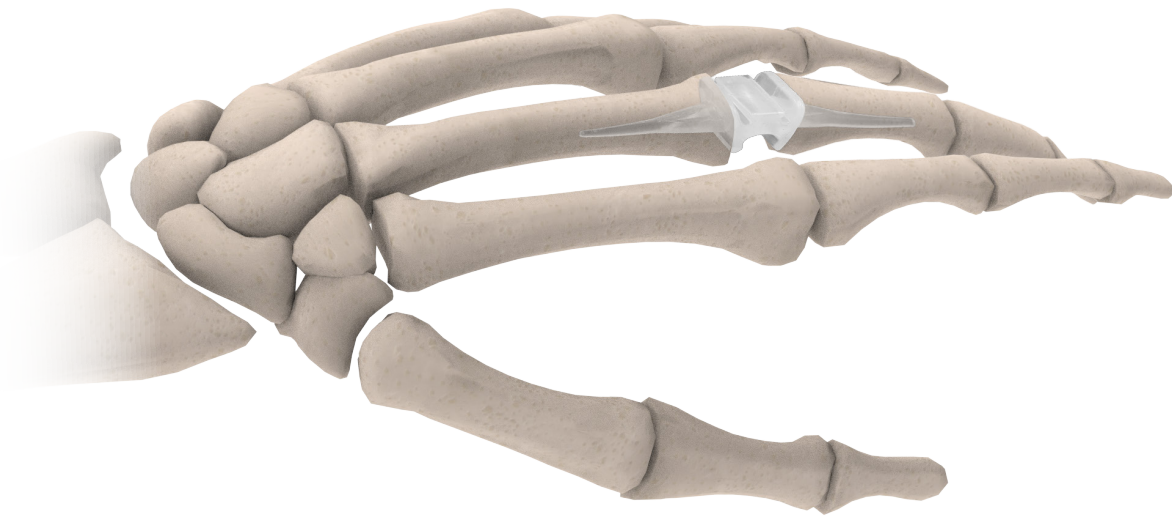

ITEM #	DESCRIPTION
DDG3T01001	DIGITALIS MCP SPACER – SIZE 1
DDG3T01002	DIGITALIS MCP SPACER – SIZE 2
DDG3T01003	DIGITALIS MCP SPACER – SIZE 3
DDG3T01004	DIGITALIS MCP SPACER – SIZE 4
DDG3T01005	DIGITALIS MCP SPACER – SIZE 5
DDG3T02001	DIGITALIS PIP SPACER – SIZE 1
DDG3T02002	DIGITALIS PIP SPACER – SIZE 2
DDG3T02003	DIGITALIS PIP SPACER – SIZE 3
DDG3T02004	DIGITALIS PIP SPACER – SIZE 4

Clover Staple™

The BioPro® Clover Staple™ product line consists of a 3-leg and 4-leg nitinol memory-alloy staple specifically designed for four corner fusions and other limited wrist fusions in cases of carpal instability, Scaphoid Nonunion Advanced Collapse (SNAC) and Scapholunate Advanced Collapse (SLAC). The Clover Staple™ activates at patient body temperature, providing dynamic, centralized compression designed to speed up the fusion process.

- Engineered to allow surgeons to use a single device and streamlined dorsal approach in intercarpal fusions, leaving the articular surfaces undisturbed.
- The 1mm profile and specially designed instrumentation allow the staples to sit flush, preventing dorsal impingement while maintaining maximum fusion mass.

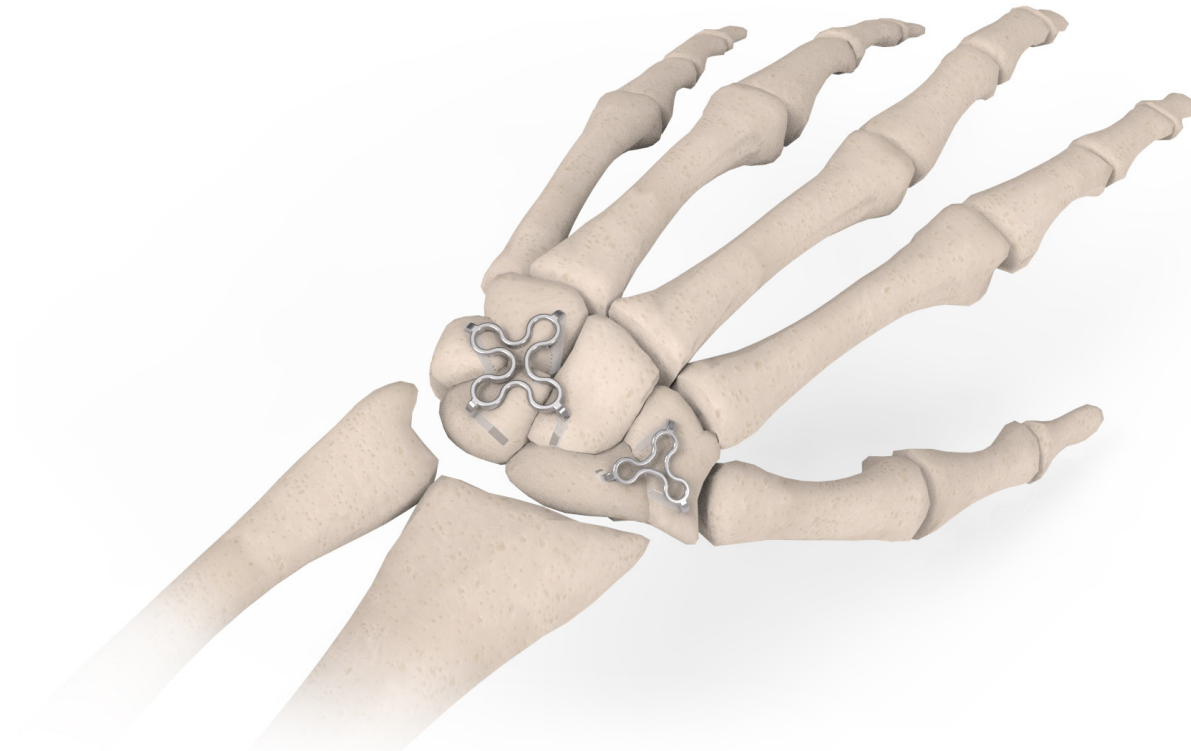
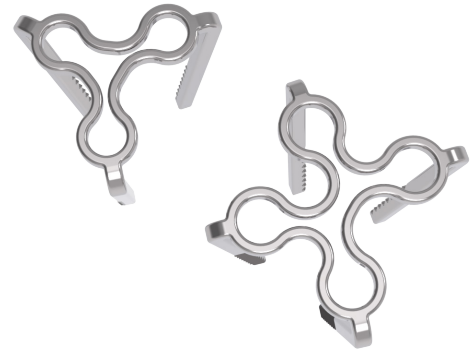

Item #	Description
18259	4-Leg 10 X 8 X 10mm
18260	4-Leg 10 X 8 X 12.5mm
18261	4-Leg 10 X 8 X 15mm
18062	4-Leg 14 X 12 X 10mm
18063	4-Leg 14 X 12 X 12.5mm
18064	4-Leg 14 X 12 X 15mm
18065	4-Leg 18 X 16 X 10mm
18066	4-Leg 18 X 16 X 12.5mm
18067	4-Leg 18 X 16 X 15mm

Item #	Description
18262	3-Leg 10 X 8 X 10mm
18263	3-Leg 10 X 8 X 12.5mm
18264	3-Leg 10 X 8 X 15mm
18068	3-Leg 14 X 12 X 10mm
18069	3-Leg 14 X 12 X 12.5mm
18070	3-Leg 14 X 12 X 15mm
18071	3-Leg 18 X 16 X 10mm
18072	3-Leg 18 X 16 X 12.5mm
18073	3-Leg 18 X 16 X 15mm

Memory Staple

The BioPro Memory Staple is a 2-leg nitinol memory-alloy staple designed for bone fixation in the hand. The unique S-Bend bridge of the Memory Staple ensures even compression across the fusion site, while maintaining a low profile against the bone.

The Memory Staple is individually sterile packaged and available in 17 standard sizes. The packaging features a color coding system that coordinates staple leg size with drill diameter. The system offers both standard legs and offset legs. Standard leg staples are utilized when a flush surface exists while the offset staples offer different leg lengths to accommodate uneven bone surfaces.

- 17 standard sizes with varying bridge widths, leg lengths, and wire sizes, allowing for fixation in most hand procedures
- Easy to use instrumentation for fast and direct visual insertion may reduce procedure time
- Body-heat activated design offers delayed compression, ensuring proper seating and positioning of the staple prior to compression

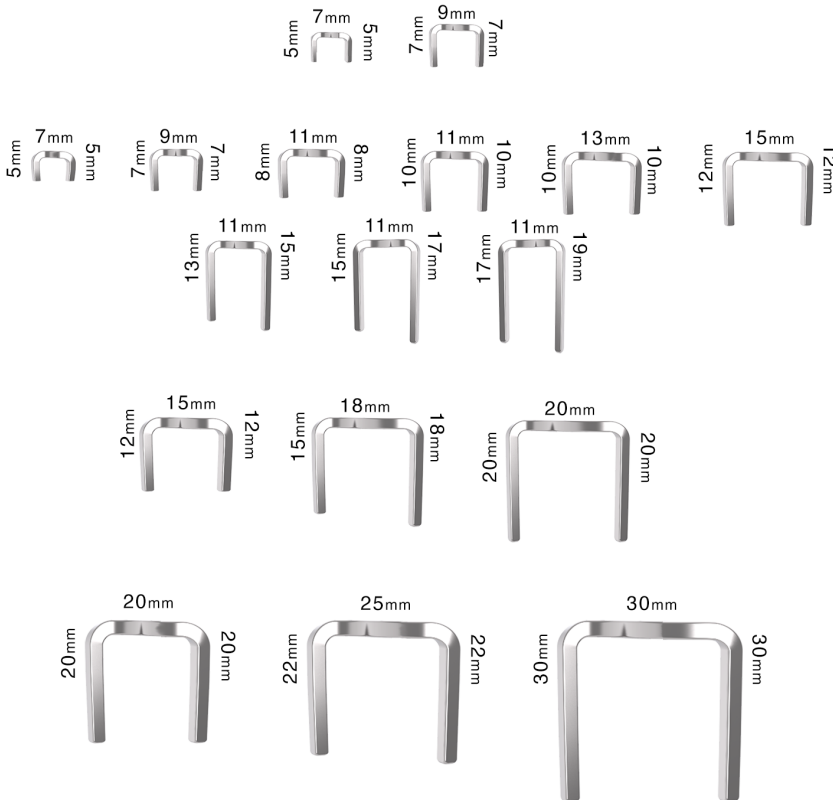
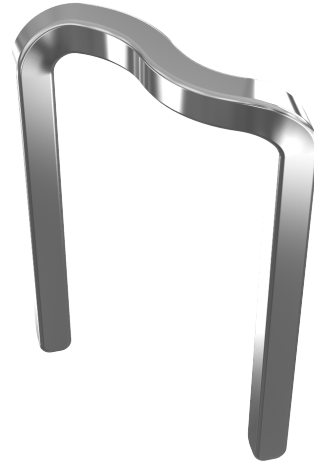

Item #	Bridge Width	Leg Length	Wire Size
17637	7mm	5mm	1.2mm
17628	7mm	5mm	1.5mm
17638	9mm	7mm	1.2mm
17629	9mm	7mm	1.5mm
17630	11mm	8mm	1.5mm
17631	11mm	10mm	1.5mm
17634	11mm	15mm/13mm	1.5mm
17635	11mm	17mm/15mm	1.5mm
17636	11mm	19mm/17mm	1.5mm
17632	13mm	10mm	1.5mm
17633	15mm	12mm	1.5mm
17625	15mm	12mm	2.0mm
17626	18mm	18mm/15mm	2.0mm
17627	20mm	20mm	2.0mm
17622	20mm	20mm	2.0x3.0mm
17623	25mm	22mm	2.0x3.0mm
17624	30mm	30mm	2.0x3.0mm

Digital Compression Screw (DCS)

The Digital Compression Screw (D.C.S.) is a solid, stainless steel screw specifically designed to address digital fusions. The 1.5mm and 1.8mm diameters range from 20mm to 55mm in length, allowing for fusion of the DIPJ, PIPJ, or both. The Digital Compression Screw features a 1.1mm shaft diameter with either 1.5mm or 1.8mm threads for a lag screw design. Our unique over-drilling technique allows compression and easy removal post fusion.



- Lag design combined with a unique over-drilling technique allows for compression across the fusion site
- Threads purchase into cortical bone, improving stability and reducing the chance of rotation or residual flexion

Item #	Description	Length
17201	Digital Compression Screw 1.5mm	20mm
17202	Digital Compression Screw 1.5mm	25mm
17110	Digital Compression Screw 1.5mm	30mm
17111	Digital Compression Screw 1.5mm	35mm
17112	Digital Compression Screw 1.5mm	40mm
17113	Digital Compression Screw 1.5mm	45mm
17114	Digital Compression Screw 1.5mm	50mm
17115	Digital Compression Screw 1.5mm	55mm
17203	Digital Compression Screw 1.8mm	20mm
17204	Digital Compression Screw 1.8mm	25mm
17116	Digital Compression Screw 1.8mm	30mm
17117	Digital Compression Screw 1.8mm	35mm
17118	Digital Compression Screw 1.8mm	40mm
17119	Digital Compression Screw 1.8mm	45mm
17120	Digital Compression Screw 1.8mm	50mm
17121	Digital Compression Screw 1.8mm	55mm

HBS® Headless Compression Screws

The HBS® Headless Cannulated Compression Screw System features 2.5mm and 3.0mm screws with various cutting tip styles available. The screws are manufactured from implant grade Titanium and are individually sterile packaged.

The 2.5mm and 3.0mm self-tapping (ST) are available from 10mm to 30mm in length with 1mm increments to allow for maximal bone purchase.

The 2.5mm and 3.0mm self-drilling and self-tapping (SDST) are available from 10mm to 40mm in length with 2mm increments. The self-cutting teeth eliminate the need for pre-drilling.

The 3.0mm Fully Threaded (FT) screw is available from 10 to 40mm in length with 2mm increments. The fully threaded design allows for downsizing without sacrificing thread purchase.



HBS ST SCREWS		
Length (mm)	Ø2.5 (Purple)	Ø3.0 (Grey)
10	19545	19566
11	19546	19567
12	19547	19568
13	19548	19569
14	19549	19570
15	19550	19571
16	19551	19572
17	19552	19573
18	19553	19574
19	19554	19575
20	19555	19576
21	19556	19577
22	19557	19578
23	19558	19579
24	19559	19580
25	19560	19581
26	19561	19582
27	19562	19583
28	19563	19584
29	19564	19585
30	19565	19586

HBS SDST SCREWS		
Length (mm)	Ø2.5 (Rose)	Ø3.0 (Blue)
10	20500	20516
12	20501	20517
14	20502	20518
16	20503	20519
18	20504	20520
20	20505	20521
22	20506	20522
24	20507	20523
26	20508	20524
28	20509	20525
30	20510	20526
32	20511	20527
34	20512	20528
36	20513	20529
38	20514	20530
40	20515	20531

HBS Fully Threaded	
Length (mm)	Ø3.0 (Silver)
10	22540
12	22541
14	22542
16	22543
18	22544
20	22545
22	22546
24	22547
26	22548
28	22549
30	22550
32	22551
34	22552
36	22553
38	22554
40	22555

*Shaded area indicates special order only

Go-EZ™ Headed Compression Screws

The Go-EZ™ Headed Cannulated Compression Screw System features screws from 2.0mm to 6.5mm in diameter. The screws are manufactured from implant grade Titanium and are individually sterile packaged.

The system features low profile heads minimizing implant prominence and self-drilling and self-cutting tips for effortless insertion without pre-drilling.

Our screw sizes and quantities are customizable to the surgeon's/hospital's needs or preferences.



Go-EZ Cannulated Screws						
Length (mm)	Ø2.0 (Blue)	Ø2.5 (Purple)	Ø3.0 (Gold)	Ø3.5 (Green)	Ø4.0 (Grey)	Ø4.5 (Brown)
6	18162	18172	18185	18203	18226	18239
8	18163	18173	18186	18204	18227	18240
10	18164	18174	18187	18205	18228	18241
12	18165	18175	18188	18206	18229	18242
14	18166	18176	18189	18207	18230	18243
16	18167	18177	18190	18208	18231	18244
18	18168	18178	18191	18209	18232	18245
20	18169	18179	18192	18210	18233	18246
22	18170	18180	18193	18211	18234	18247
24	18171	18181	18194	18212	18235	18248
26	19265	18182	18195	18213	18236	18249
28	19266	18183	18196	18214	18237	18250
30	19267	18184	18197	18215	18238	18251
32	19268	19250	18198	18216	19041	19031
34	19269	19251	18199	18217	19042	19032
36	19270	19252	18200	18218	19043	19033
38	19271	19253	18201	18219	19044	19034
40	19272	19254	18202	18220	19045	19035
42	19273	19255		18221	19046	19036
44	19274	19256		18222	19047	19037
46	19275	19257		18223	19048	19038
48	19276	19258		18224	19049	19039
50	19277	19259		18225	19050	19040

BIOLOGICALLY ORIENTED PROSTHESES
BIOPRO

Call us at 1-810-982-7777 to schedule a case today.

This content is provided as an educational tool only and is not meant as medical advice in the usage of specific BioPro products. A healthcare professional must use their professional judgment in making any final determinations in product usage and technique. The product's Instructions for Use, should always be reviewed prior to surgery. Postoperative management is patient-specific and dependent on the treating professional's assessment. Individual results will vary and not all patients will experience the same postoperative activity level or outcomes. This information does not constitute medical, legal, or any other type of professional advice and should not be relied upon as such. It is not to be redistributed, duplicated, or disclosed without the express written consent of BioPro, Inc.



BioPro, Inc.
2929 Lapeer Road, Port Huron, MI 48060, USA
info@bioproimplants.com | 1-810-982-7777
www.bioproimplants.com



intertek