

Horizon Subtalar

Conservative treatment of flatfoot and PTTD.¹

The BioPro Horizon Subtalar incorporates a smooth, slightly tapered lateral trailing edge; assuring that the talus makes contact with a smooth, flat surface when the foot is pronated, not a sharp thread.

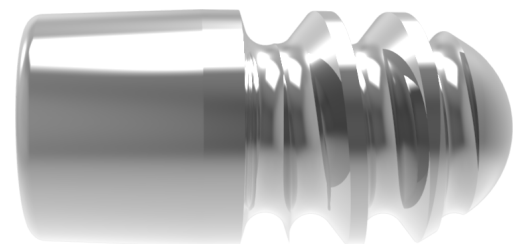
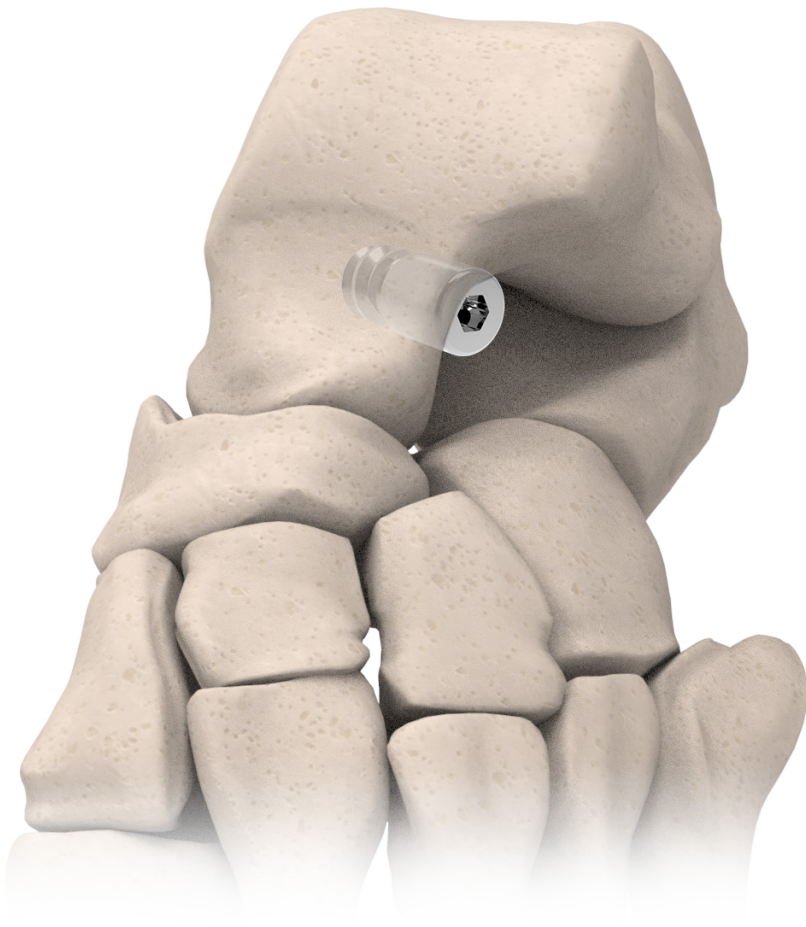

Horizon Subtalar

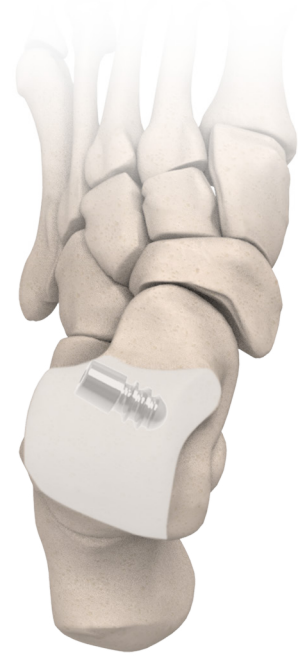
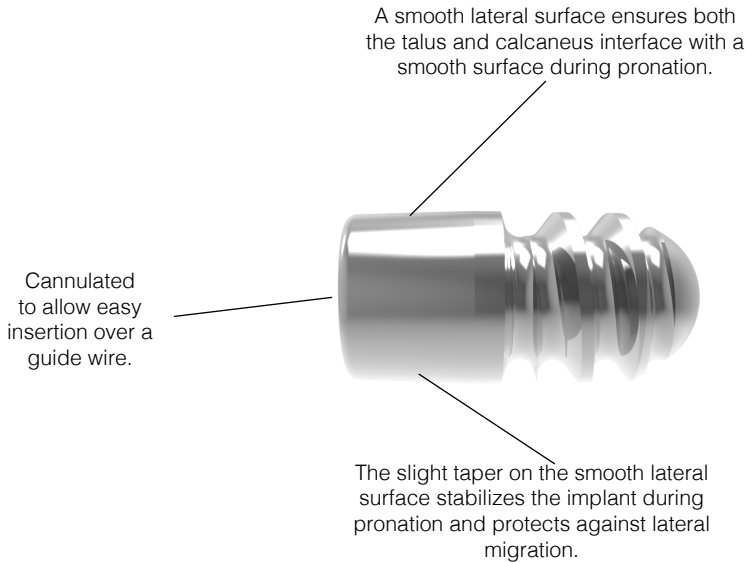

	Specifications
Material	Titanium
Length (mm)	16.4
Outer Diameter (mm)	6*, 8, 9, 10, 11, 12

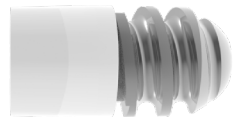

A hybrid design incorporates a polyethylene sleeve over the lateral portion of the implant, offering a softer, more forgiving surface to interface with the talus and calcaneus.

*Only available in the standard design

Visit www.bioproimplants.com or call us at (810) 982-7777

1. Ozan, F., Dođar, F., Gençer, K., Koyuncu, Ş., Vatansever, F., Duygulu, F., & Altay, T. (2015). Symptomatic flexible flatfoot in adults: subtalar arthroereisis. *Therapeutics and Clinical Risk Management*, 11, 1597–1602. <http://doi.org/10.2147/TCRM.S90649>



+1-810-982-7777
 info@bioproimplants.com
 2929 Lapeer Road
 Port Huron, MI 48060



MKT27 01