

# Accu-Cut<sup>®</sup> Osteotomy Guide System

Accurate and consistent hallux valgus correction.<sup>1</sup>

The BioPro<sup>®</sup> Accu-Cut Osteotomy Guide System provides precise and repeatable osteotomies for many types of bunion correction surgery.



# Accu-Cut® Osteotomy Guide System

Using an Accu-Cut Guide in conjunction with your preferred osteotomy ensures precision with all cuts<sup>1</sup> for optimal bone contact and improved fusion success. The sterile packed system provides the surgeon with everything needed to perform the desired osteotomy.



## Choose Your Osteotomy.

### Chevron (Austin) Guide

The standard Chevron Guide offers a 55° angle for precise cuts on a classic, predictable osteotomy. (ref 19505)

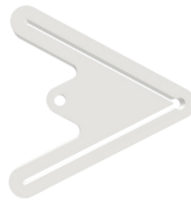

### Scarf Guide

The Scarf Guide is a "Z" shaped guide to assist in the popular Scarf procedure. The system includes two guides, a large and a small, with each guide having multiple slots for the dorsal and plantar cuts. This allows for customization of the osteotomy based on the anatomy of the patient's metatarsal. (ref 19511)

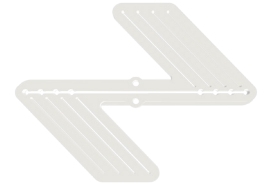

### Youngswick Guide

The Youngswick Guide features two dorsal slots, spaced 1mm, 2mm, or 3mm apart. This allows the surgeon to shorten and plantarflex the metatarsal head by 1, 2, or 3 mm, while providing lateral transposition. (ref 19506/19507/19508)



### 2-Stage Guide

The 2-Stage Guide allows correction of PASA or DMAA, similar to the Reverdin-Gerbert procedure. The system includes a Stage-1 guide for a standard Chevron cut, along with three angled Stage-2 guides allowing 5°, 10°, or 15° of rotation along with lateral transposition. (ref 19509)

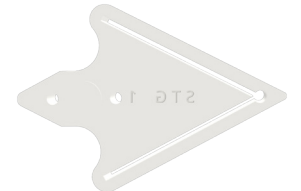

### Long-Arm Chevron Guide

The Long-Arm Guide is a 45° chevron with a long dorsal arm. This offers more surface area along the dorsal cut for multiple screw fixation. Additionally, the guide offers three proximal mounting holes, spaced 11° apart, allowing intra-operative adjustment of the cut angle. (ref 19510)

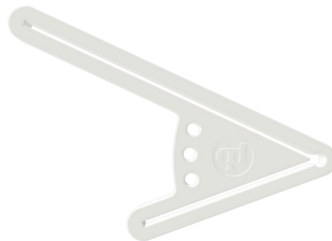

### DMAA Guide

The DMAA Guide allows for correction of DMAA or PASA with one simple guide. The system includes a Chevron guide with a second dorsal slot, angled at 10°. This allows for lateral transposition plus rotation of the head. (ref 19720)



Visit [www.bioproimplants.com](http://www.bioproimplants.com) or call us at (810) 982-7777

1. Evaluation of surgical experience and the use of an osteotomy guide on the apical angle of an Austin osteotomy The Foot, Volume 18, Issue 3, Pages 159-164 V.J. Hetherington, J.S. Kawalec-Carroll, J. Melillo-Kroleski, T. Jones, M. Melillo, N. McFarland, M. Blazer, J.A. Favazzo



+1-810-982-7777  
 info@bioproimplants.com  
 2929 Lapeer Road  
 Port Huron, MI 48060

